



STAINLESS STEEL

# SPECLINE 14 Ga. Fabricated Sinks

## Single Compartment



**Item #:** \_\_\_\_\_ **Qty #:** \_\_\_\_\_

**Model #:** \_\_\_\_\_

**Project #:** \_\_\_\_\_

**FEATURES:**

- Continuous Apron Design
- Backsplash has tile edge for ease of installation.
- Sink bowls are 3/4" coved corner and meet NSF requirements.
- Rolled Rim Edge for additional strength.
- Sink Bowls are 14" deep for greater capacity.
- Stainless Steel Legs and Cross Bracing.

**CONSTRUCTION:**

- All TIG welded.
- Welded areas blended to match adjacent surfaces and to a satin finish.

**MATERIAL:**

- 1 5/8" diameter stainless steel legs with 1" adjustable stainless steel bullet feet.
- Entire unit is 14 gauge 304 stainless steel.
- Stainless Steel Gussets.

**MECHANICAL:**

- Supply is 1/2" IPS hot & cold.
- Faucet holes on 8" centers.
- Faucets are not included (**see accessories**).
- Waste drains are 1 1/2" IPS S/S basket type, located in center of sink bowl, and are included.

MODEL #	BOWL SIZE	O.A. Length	# of Drbds.
FS-1-1818	18" x 18"	23"	0
FS-1-1818-18RorL	18" x 18"	38 1/2"	1
FS-1-1824	18" x 24"	23"	0
FS-1-1824-18R or L	18" x 24"	38.5"	1
FS-1-1824-24R or L	18" x 24"	44.5"	1
FS-1-1824-18RL	18" x 24"	54"	2
FS-1-1824-24RL	18" x 24"	66"	2
FS-1-2424	24" x 24"	29"	0
FS-1-2424-18R or L	24" x 24"	44.5"	1
FS-1-2424-24R or L	24" x 24"	50.5"	1
FS-1-2424-18RL	24" x 24"	60"	2
FS-1-2424-24RL	24" x 24"	72"	2
FS-1-3024	30" x 24"	35"	0
FS-1-3024-24R or L	30" x 24"	56.5"	1
FS-1-3024-24RL	30" x 24"	78"	2
FS-1-3624	36" x 24"	41"	0
FS-1-3624-24R or L	36" x 24"	62.5"	1
FS-1-3624-24RL	36" x 24"	84"	2

ACCESSORIES	Model #	Qty
DRAINS		
FAUCETS		

**Customer Service Available To Assist You 1-800-645-3166 8:30 am - 8:00 pm E.S.T.**  
 Email Orders To: [customer@advancetabco.com](mailto:customer@advancetabco.com). For Smart Fabrication™ Quotes, Email To: [smartfab@advancetabco.com](mailto:smartfab@advancetabco.com) or Fax To: 631-586-2933

**NEW YORK**  
Fax: (631) 242-6900

**GEORGIA**  
Fax: (770) 775-5625

**TEXAS**  
Fax: (972) 932-4795

**NEVADA**  
Fax: (775) 972-1578

# DIMENSIONS and SPECIFICATIONS

TOL Overall: ± .500" Interior: ± .250"

ALL DIMENSIONS ARE TYPICAL

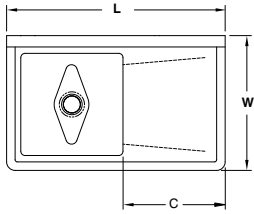

1 COMP - 1 DRBD

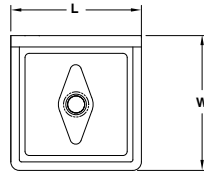

1 COMP

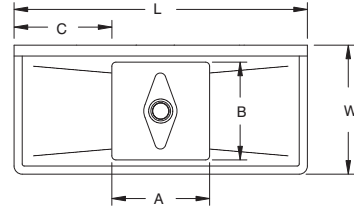

1 COMP - 2 DRBDs

MODEL #	Length L	Width W	Bowl Size A & B	Drbd. Length C	# of Drbds.	Drbd. Location	Wt	Cu.
FS-1-1818	23"	23.5"	18" x 18"	N/A	0	None	60 lbs	11
FS-1-1818-18RorL	38.5"	23.5"	18" x 18"	18"	1	Specify	75 lbs.	17
FS-1-1824	23"	29.5"	18" x 24"	N/A	0	None	78 lbs	16
FS-1-1824-18RorL	38.5"	29.5"	18" x 24"	18"	1	Specify	92 lbs	25
FS-1-1824-24RorL	44.5"	29.5"	18" x 24"	24"	1	Specify	105 lbs	28
FS-1-1824-18RL	54"	29.5"	18" x 24"	18"	2	Both	175 lbs	34
FS-1-1824-24RL	66"	29.5"	18" x 24"	24"	2	Both	198 lbs	40
FS-1-2424	29"	29.5"	24" x 24"	N/A	0	None	90 lbs	19
FS-1-2424-18RorL	44.5"	29.5"	24" x 24"	18"	1	Specify	110 lbs	28
FS-1-2424-24RorL	50.5"	29.5"	24" x 24"	24"	1	Specify	119 lbs	34
FS-1-2424-18RL	60"	29.5"	24" x 24"	18"	2	Both	185 lbs	37
FS-1-2424-24RL	72"	29.5"	24" x 24"	24"	2	Both	209 lbs	44
FS-1-3024	35"	29.5"	30" x 24"	N/A	0	None	115 lbs	23
FS-1-3024-24RorL	56.5"	29.5"	30" x 24"	24"	1	Specify	132 lbs	35
FS-1-3024-24RL	78"	29.5"	30" x 24"	24"	2	Both	150 lbs	47
FS-1-3624	41"	29.5"	36" x 24"	N/A	0	None	125 lbs	26
FS-1-3624-24RorL	62.5"	29.5"	36" x 24"	24"	1	Specify	143 lbs	39
FS-1-3624-24RL	84"	29.5"	36" x 24"	24"	2	Both	165 lbs	51

