



MBPT SERIES

Pizza Prep Units

MBPT67



MODELS

- MBPT44
- MBPT67
- MBPT93

FEATURES

CONSTRUCTION

- Stainless steel interior and exterior
- Foamed-in-place with low ODP polyurethane insulation
- Wall thickness: 1.75"
- Insulated top lids
- 1/2" thick, 19" deep reversible cutting board
- Standard 1/3 size pans
- Adjustable heavy-duty vinyl-coated shelves
- 6" diameter casters

DOORS

- Self-closing
- Heavy-duty ergonomic handle
- Standard door swing configuration:
 - MBPT44 hinged left
 - MBPT67 left hinged left, right hinged right
 - MBPT93 left hinged left, middle hinged left, right hinged right

Door width:

- MBPT44 29⁷/₈"
- MBPT67 and MBPT93 26"

REFRIGERATION

- Self-contained forced air refrigeration system
- Refrigerant:
 - MBPT44 and MBPT67 R134a
 - MBPT93 R404A
- Temperature range: 32° to 40°F (0° to 4° C)

WARRANTY

- Standard limited four year extended compressor and one year limited parts and labor

OPTIONS

- Single or double overshelf



- Refrigerated drawers



BID SPECIFICATIONS

Item no. MBPT. Provide _____ Pizza Prep Unit(s), Master-Bilt model no. MBPT_____.

Prep unit will be constructed of stainless steel interior and exterior. Standard features will include a 1/2" thick, 19" deep reversible cutting board, 1/3 size pans, insulated lids,

adjustable heavy-duty vinyl-coated shelves and 6" diameter casters.

The refrigeration system will be self-contained. MBPT44 and MBPT67 will contain R-134a refrigerant while the MBPT93 will contain R404A. The temperature range will be

32° to 40°F (0° to 4° C).

Prep unit to have standard limited 4 year extended compressor warranty and one year limited parts and labor warranty.

Prep unit to be UL, C-UL and ETL Sanitation listed.

TECHNICAL SPECIFICATIONS

MODEL	DIMENSIONS (in.)			DIMENSIONS (mm)			VOLTS	AMPS	UNIT H.P.	NO. OF DOORS	NO. OF SHELVES	NO. OF PANS	CAP. CU. FT.	SHIP CU. FT.	SHIP WT. (LB/KG)
	L	D*	H**	L	D*	H**									
MBPT44	44 ³ / ₈	36 ¹ / ₂	42 ⁷ / ₈	1127	927	1089	115	6.5	3/8	1	2	(6) 1/3	9.7	43.2	309/140
MBPT67	67	36 ¹ / ₂	42 ⁷ / ₈	1702	927	1089	115	6.5	3/8	2	4	(9) 1/3	17.8	64.4	548/249
MBPT93	93 ¹ / ₄	36 ¹ / ₂	42 ⁷ / ₈	2369	927	1089	115	7.5	1/2	3	6	(12) 1/3	27.2	89.0	698/317

*Depth includes cutting board. **Height includes casters.

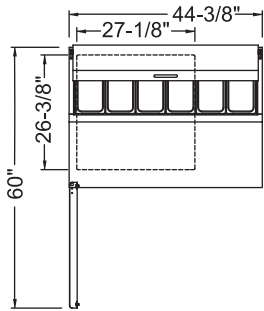

MBPT44 PLAN VIEW

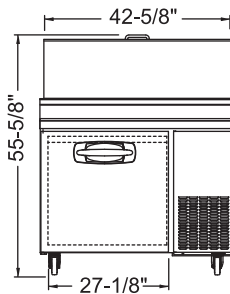

MBPT44 ELEVATION VIEW

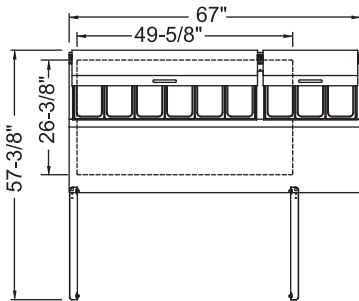

MBPT67 PLAN VIEW

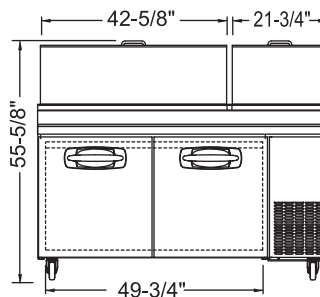

MBPT67 ELEVATION VIEW

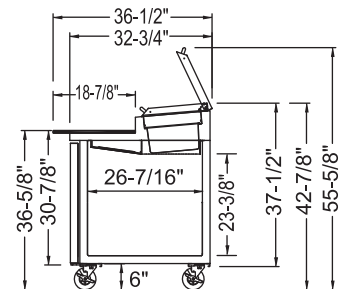

SIDE VIEW - ALL MODELS

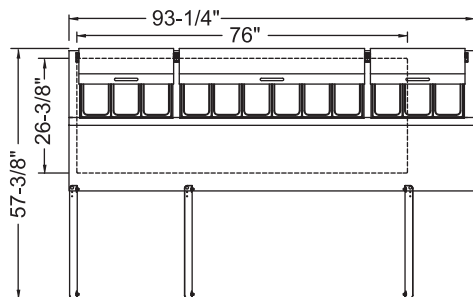

MBPT93 PLAN VIEW

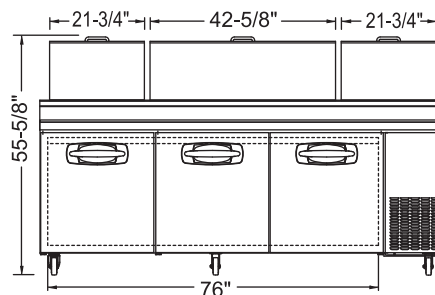

MBPT93 ELEVATION VIEW

HOOKUP

All models via plug in, 9 foot long flexible three wire 14/3 cord with molded plug.

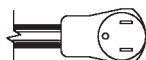

NEMA 5-15P

NOTE: Cabinet designed for optimum performance in air-conditioned area at 75°F ambient and 55% relative humidity. All specifications subject to change without notice.