



BMG-74



The only bottom mounted glass door reach-ins with low maintenance bare tube condenser coils.

BMG SERIES

Bottom Mounted Medium Temp Glass Door Merchandisers

MODELS

- BMG-27
- BMG-48
- BMG-52
- BMG-74
- BMG-80

FEATURES

CONSTRUCTION

- 24 gauge painted steel interior and exterior
- Cord and plug standard on all self-contained models
- Replaceable magnetic vinyl door gaskets
- Five white epoxy-coated, heavy-duty, welded wire shelves with price tag molding per door (four cantilever and one bottom)
- Cantilever shelves are two-position and adjustable in 1" increments
- Equipped with high output 800 milliamp lamps and ballasts
- Independent on/off light switch
- 2" foamed-in-place "zero ODP" urethane insulation

FINISH

- Sparkling white polyester enamel interior and exterior

DOORS

- Door size:
 BMG-27 30" x 63"
 BMG-48/74 25¹/₈" x 63"
 BMG-52/80 27¹/₈" x 63"
- Black door rails and handles
- Extra large, auto-close, triple pane, safety glass doors
- 90° hold-open feature
- Adjustable torsion bar hinges
- Door hinges easily adjustable for closing tension and leveling

REFRIGERATION

- Self-contained, factory tested, bottom mounted refrigeration system
- Top mounted low profile interior fan housing
- Automatic condensate evaporator
- Refrigerant: R-134a
- Minimum 4" clearance required between cabinet back and wall

- Temperature range: 34° to 41°F (1° to 5°C)
- R-factor (insulation efficiency rating): 17.24

WARRANTY

- Standard limited three year extended compressor and two year limited parts and labor

OPTIONS

- Add suffix "R" for remote system (For BMG-48 and BMG-74 only)
- Custom colors
- Baskets
- Casters
- Additional shelves



BMG SERIES BOTTOM MOUNTED MEDIUM TEMP GLASS DOOR MERCHANDISERS

TECHNICAL SPECIFICATIONS

MODEL	DIMENSIONS (in.)			DIMENSIONS (mm)			VOLTS	AMPS	UNIT H.P.	NO. OF DOORS	CAP. CU. FT.	SHIP CU. FT.	SHIP WT. (LB/KG)
	L	D	H	L	D	H							
BMG-27	31	36 ³ / ₄	79	787	933	2007	115	8.0	1/3	1	27.5	79.0	520/236
BMG-48	52	36 ³ / ₄	79	1321	933	2007	115	8.0	1/3	2	49.0	117.0	755/343
BMG-52	56	36 ³ / ₄	79	1422	933	2007	115	8.0	1/3	2	53.0	128.0	775/352
BMG-74	78	36 ³ / ₄	79	1981	933	2007	115	12.0	1/2	3	75.5	168.0	1025/466
BMG-80	84	36 ³ / ₄	79	2134	933	2007	115	12.0	1/2	3	81.6	185.0	1065/484

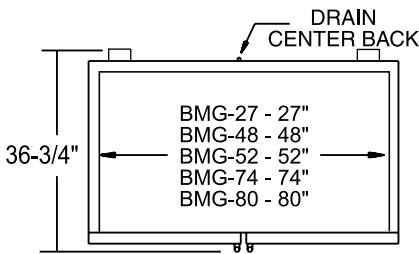

PLAN VIEW

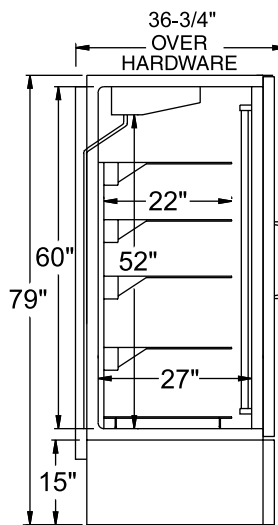

SIDE VIEW

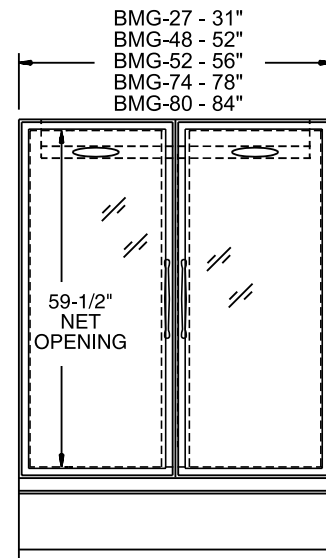

ELEVATION VIEW

LISTINGS



HOOKUP

Via plug in, 9 foot long, flexible three wire 14/3 cord with molded plug.



BID SPECIFICATIONS

Item no. BMG-_____ .
Provide _____ ()
Bottom Mounted Medium Temp Glass Door Merchandiser(s), Master-Bilt model no. BMG-_____ .

Merchandiser to be provided with adjustable torsion bar hinges, top mounted low profile interior fan housing, automatic condensate evaporator, 800 milliamp

bulbs, independent on/off light switch and black door rails and handles. Merchandiser also to be equipped with five white epoxy-coated shelves (four cantilever and one bottom) with price tag molding per door.

The refrigeration system is to be bottom mounted, self-contained and use R-134a refrigerant. System will contain a low

maintenance bare tube condenser coil. The temperature range will be 34° to 41°F (1° to 5°C).

Merchandiser to have standard limited three year extended compressor warranty and two year limited parts and labor warranty. Merchandiser to be UL, C-UL and NSF listed.

NOTE: Cabinet designed for optimum performance in air-conditioned area at 75°F ambient and 55% relative humidity. All specifications subject to change without notice.



908 Highway 15 North • New Albany, MS 38652
PHONE: 800-647-1284 or 662-534-9061 • FAX: 800-232-3966 or 662-534-6049 • www.master-bilt.com

