

CORNER FILLER SECTIONS INSIDE 90° CORNERS WITH FLAT TOP

Perlick Features

- All stainless steel.
- Underside reinforced.

MODEL NOS.

- TS Series
- 7055-12
 - 7055-13

MODEL NOS.

- TSD Series
- 7055D12
 - 7055D13

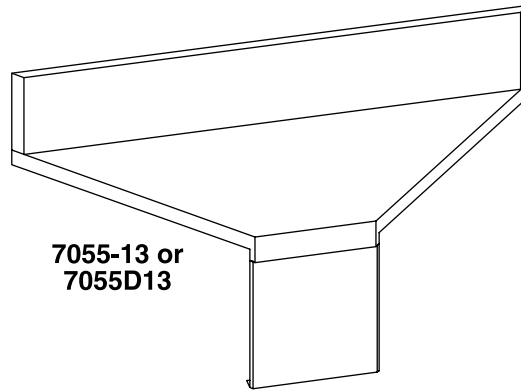
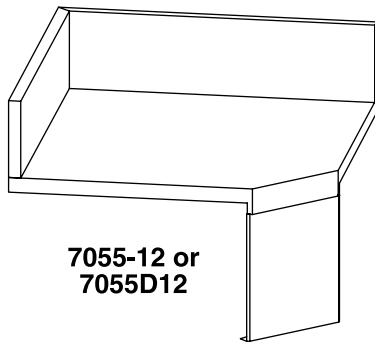

Sizes and Specifications - Corner Filler Sections Inside 90° Corners w/Flat Top

Job _____
 Area _____
 Item No. _____
 Model No. _____

MODEL NOS. (TS Series)	7055-12	7055-13
MODEL NOS. (TSD Series)	7055D12	7055D13
DESCRIPTION	90° Full	90° Clip
SHIP WT lbs. (kg)	20 (9)	20 (9)
GENERAL PARTS	Stainless steel.	
BACKSPLASH	Stainless steel 6" high (4" high optional) with 1" return at top, mechanically fastened and sealed.	

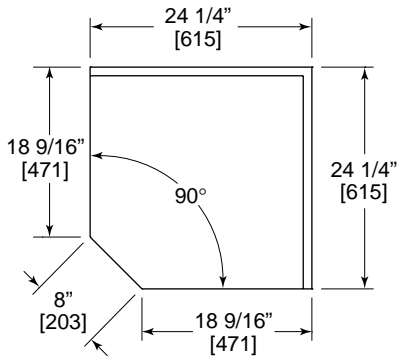

7055-12

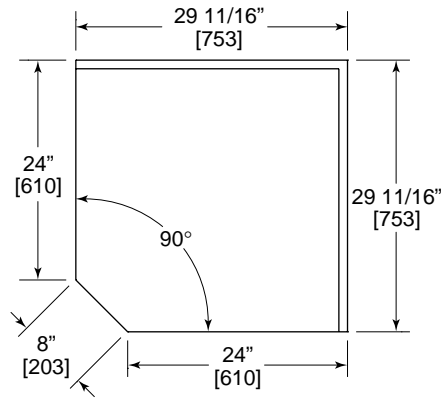

7055D12

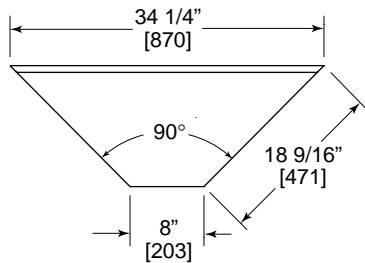

7055-13

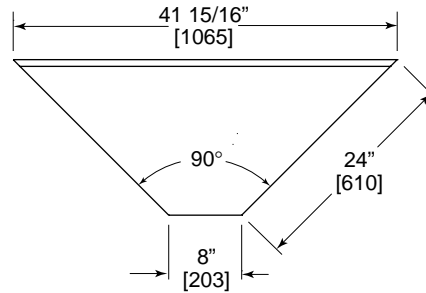

7055D13



8300 West Good Hope Road • Milwaukee, WI 53223 • Phone 414-353-7060 • Fax 414-353-7069
 Toll Free 800-558-5592 • E-Mail: Perlick@Perlick.com • www.Perlick.com

Perlick is committed to continuous improvement.
 Therefore, we reserve the right to change specifications without prior notice.

Form No. CF01-1
 Rev. 03.30.05