

BOTTLE COOLERS

Perlick Features

- Two, three, four, five, six and eight foot models.
- Stainless steel interior standard.
- Stainless or black vinyl coated exteriors.
- Reinforced door mullion will not bend or sag.
- Dent resistant heavy gauge doors.
- Two inch foamed-in-place walls save on energy costs and add strength.
- Heavy duty construction.
- Twenty four inch front to back dimension matches depth of underbar stainless steel.
- Plug-in installation; no drain required.
- Efficient, balanced refrigeration system.
- Quiet running, high efficiency compressor.

MODEL NOS.

- BC24 Series
- BC36 Series
- BC48 Series
- BC60 Series
- BC72 Series
- BC96 Series

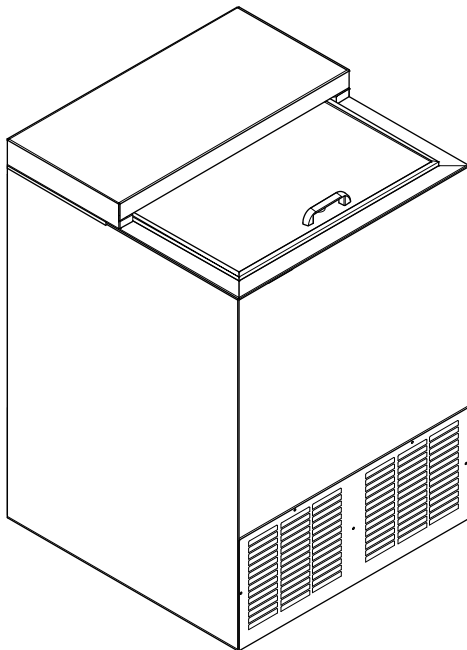

BC24 Series

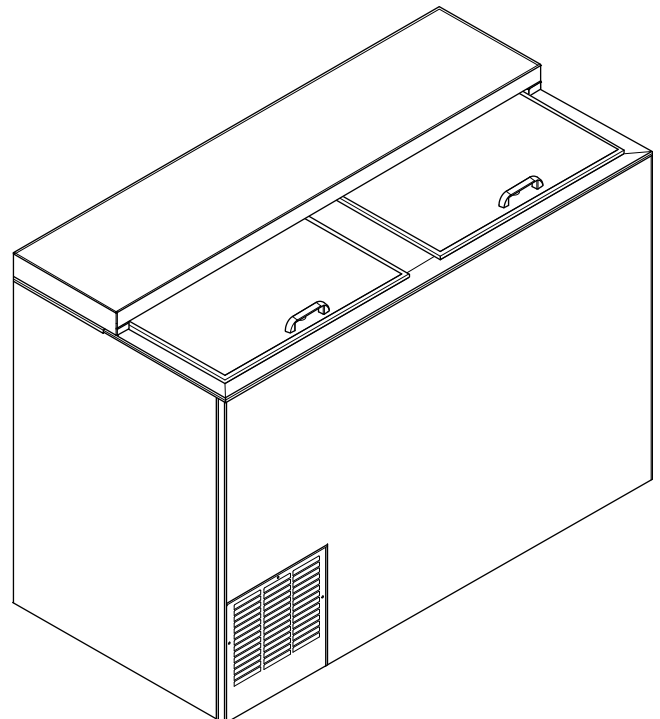

BC48 Series



8300 West Good Hope Road • Milwaukee, WI 53223 • Phone 414-353-7060 • Fax 414-353-7069
Toll Free 800-558-5592 • E-Mail: Perlick@Perlick.com • www.Perlick.com

Sizes and Specifications Bottle Coolers

Job _____
 Area _____
 Item No. _____
 Model No. _____

MODELS	BC24	BC36	BC48	BC60	BC72	BC96
LENGTH (mm)	24" (610)	36" (915)	48" (1219)	60" (1524)	72" (1828)	96" (2438)
INTERIOR CU. FT. (m ³)	3.75 (0.10)	7.83 (0.22)	11.68 (0.33)	15.53 (0.44)	19.38 (0.55)	27.08 (0.77)
CASE CAPACITY (12oz. bottles)	5.5	9.75	17.2	21	28.3	41
CASE CAPACITY (12oz. cans)	7	16	25	30	36	58
NUMBER OF BINS	2	2	3	4	5	7
CONDENSING UNIT H.P.	1/5	1/5	1/4	1/3	1/3	1/3
AMPS	3.2	3.0	5.2	7.0	6.9	7.6
SHIP WT lbs. (kg)	190 (86)	245 (111)	300 (136)	353 (160)	405 (184)	515 (235)
INTERIOR	All models have stainless steel walls and floor.					
EXTERIOR	Choice of black, stainless steel and all stainless. Black Option: Front and ends are black vinyl coated steel, back and bottom are galvanized. Stainless Steel Option: Front and ends are stainless steel, back and bottom are galvanized. All Stainless Option: Front, ends, back and bottom are all stainless steel.					
DOORS (Sliding)	Stainless steel top and bottom pans. Die cast handle. Optional locks.					
ELECTRICAL	115V, 60 Hz., 1 Phase. Furnished with 6 foot rubber plug-in cord (115V model only). Also available in 230V, 50Hz., 1 Phase AC. Carries C marking of conformity.					
PLUMBING	No drain required. Condensate evaporates automatically.					
INSULATION	2 inch foamed-in-place polyurethane insulation.					
REFRIGERATION	R134a capillary tube/type with hermetic condensing unit. Pulls out for service and cleaning.					
VENTILATION	2' model is front vented, all other models require 2" clearance from wall on either left end or back of cabinet for proper air flow.					
OPTIONAL ACCESSORIES	<ul style="list-style-type: none"> • Floor racks • Casters • Bottle opener and receiver • Interior light • Additional partitions • Bottle rails • Wine temperature (specify red or white) • Interior light kit • Adjustable legs • Roller basket shelving • Door locks 					

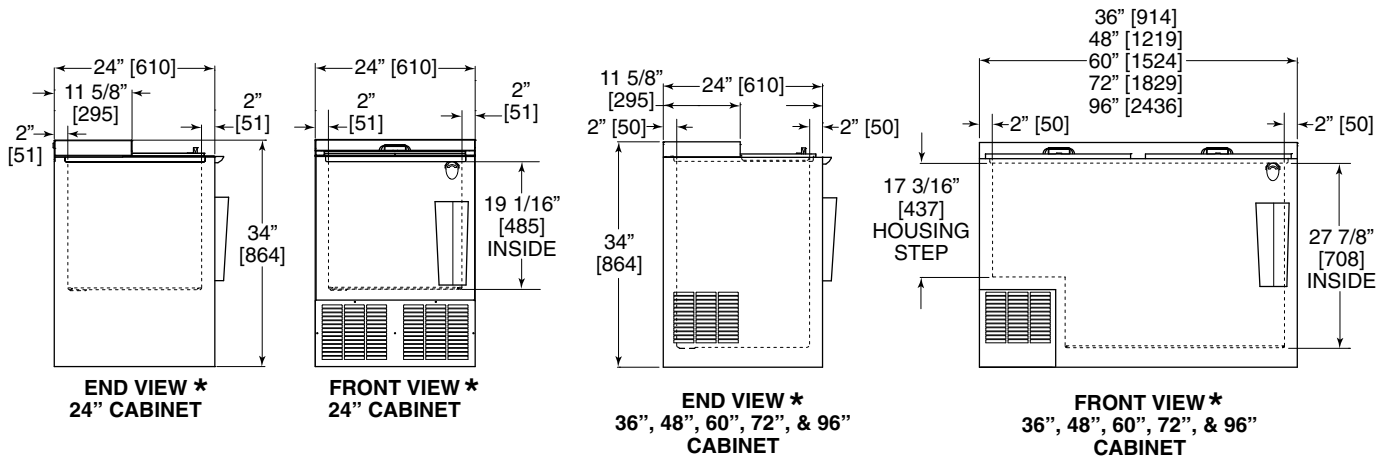

* Shown with optional opener and receiver.



8300 West Good Hope Road • Milwaukee, WI 53223 • Phone 414-353-7060 • Fax 414-353-7069
 Toll Free 800-558-5592 • E-Mail: Perlick@Perlick.com • www.Perlick.com

Perlick is committed to continuous improvement.
 Therefore, we reserve the right to change specifications without prior notice.

Form No. 130303
 Rev. 08.23.07